

LP12A/2

THE LINN SONDEK LP12

REV.	ALTERATIONS	DATE	INIT.
1	ADDED LBL 075 & G, REVD F-055 AND ADDED FOUR MECH 081. ADDED FOR CANADA ONLY AGAINST 3 PARTS.	12/02/92	JVA
2	ADDED BRUSH 575 & 100-051, CONN 875, BE MECH 014 FROM 34 TO 14, 2 QTY, BE LBL 075 FROM 0, 0 QTY TO 2, ADDED 4 & 6 1F-123, REVD F-055 WITH MECH 014, 2 100-057 WITH LBL 075.	22/02/92	SCOTT
3	ADDED 44 CONN 789 (IN PACKING). REMOVED: BRUSHING, 26-015, 28-123, 28-004, WELD 030, MECH 056, 2 x MECH 014 & 4 MECH 075, ADDED 1 x FACE 083, 2 x MECH 014, 1 x 1F-128 & 1 x 1F-133, DRAWING No. WAS PREVIOUSLY LP12A.	16/04/94	SCOTT
4	ADDED LBL 034 CE LABEL.	19/09/95	JVA

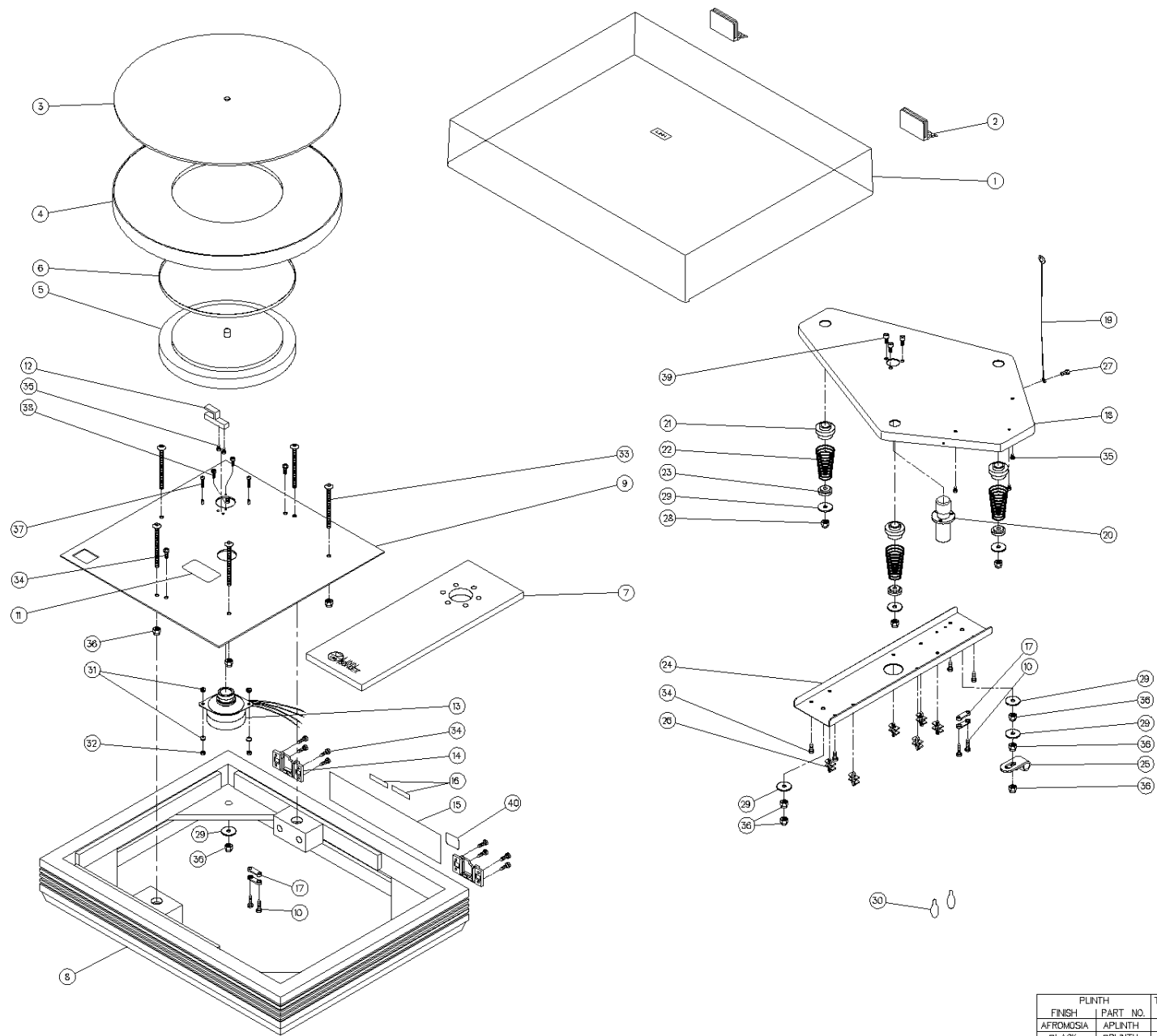

FOR CANADA ONLY

ITEM	PART NO.	DESCRIPTION	QTY	
	BASEBOARD/C	BASEBOARD FOR CANADA	1	
	7B-011	ALDBURN ELECTRONICS LABEL	1	
	2B-012	CSA LABEL	1	
	CONN 789	BLACK SUEDED VINYL STRIP 3 x 300mm	4	
	LBL 075	BOX LABEL FOR BARCODE PRINTING	1	
	PACK 158/1	ARMBORD POLYPROP BAG	1	
	1P-002	1" SELLOTAPE	1	
	1F-028	PACKING STAPLES	1	
	TAPE 002	3" CLEAR VINYL TAPE WITH LINN LOGO	1	
	PACK 064	ARMBORD WARNING LABEL	1	
	PACK 024	LP12/AXIS OUTER BOX	1	
	PACK 033	LAYER PAD	2	
	1L-069	10g SACHET SILICA GEL	1	
	2P-001/2	LINN FRAGILE PRECISION INSTRUMENT LABEL	1	
	1P-080	LID/DECK BAG	1	
	PACK 095	LP12 BOX	1	
	PACK 028	TOP SPACER	1	
	PACK 027	POLYSTYRENE INTERMEDIATE SPACER	1	
	PACK 023	POLYSTYRENE TOP TRAY	1	
	2S-602	LP12 OWNER'S MANUAL	1	
	1P-061	INNER PLATTER BAG	1	
	40	LBL 034	CE APPROVAL BADGE	1
	39	MECH 095	M4 X 10 CAP SCREW, NICKEL PLATED	3
	38	MECH 045	M3 X 10 POZI PAN SCREW STAINLESS	2
	37	1F-052	MOTOR SCREW M3	2
	36	1F-123	M5 THIN SLIPNOT LOCKNUT	11
	35	MECH 012	NO. 4 X 1/4" SUPA PAN SCREW	5
	34	MECH 016	NO. 6 X 1/2" SELF TAPPER	14
	33	2F-084	CHASSIS SCREW M5 X 60 MUSHROOM HEAD	5
	32	MECH 007	M3 FULL NUT	2
	31	70-041	MOTOR MOUNTING DOME	4
	30	PACK 062	9cc OIL FILLED GELATINE CAPSULE	2
	29	1F-126	MUDGUARD WASHER	7
	28	1F-102	M5 SLIPNOT LOCKNUT	3
	27	1F-129	NO. 6 X 1/2" HEX HEAD SELF TAPPER	1
	26	1E-336	VALHALLA SPACER	6
	25	1C-012	P-CLIP	1
	24	W/S PLATING	WIRING STRAP	1
	23	2R-001	SMALL SUSPENSION GROMMET	3
	22	2F-052	SUSPENSION SPRING	3
	21	2R-002	LARGE SUSPENSION GROMMET	3
	20	70-002/1	BEARING HOUSING WITH RED CAP	3
	19	7E-028	EARTH WIRE WITH TAGS	1
	18	70-059/1	SUBCHASSIS	1
	17	2E-015	MAINS CABLE CLAMP	4
	16	LBL 076	LABEL FOR BARCODE PRINTING	1
	15	LBL 053	LP12 LARGE LABEL	1
	14	2F-037/B	HINGE BACK PLATE	2
	13	7E-050	MOTOR WITH PULLEY & GLUED CAP	1
	12	70-071	BELT GUIDE	1
	11	2B-090	PLATTER WARNING LABEL	1
	10	MECH 575	3.5mm X 20 PAN HEAD SCREW	4
	9	TOP-PLATE	TOP PLATE	1
	8	SEE CHART	PLINTH	1
	7	2W-121/P	EKOS/BASIK ARMBORD PRINTED	1
	6	2C-050	DRIVE BELT	2
		1P-061	INNER PLATTER POLYTHENE BAG	1
		1P-071	OUTER PLATTER POLYTHENE BAG	1
		2F-050/1	POLYSTYRENE SQUARE	1
		PACK 030	POLYSTYRENE BOTTOM TRAY	1
	5	0PLAT/1	INNER PLATTER	1
	4	0PLAT/04	OUTER PLATTER	1
	3	2W-060	FELT MAT	1
	2	2F-037/H	HINGES FOR LP12	2
	1	2C-074/IF	LID WITH FEET AND BADGE	1

APLATE WPLATE

MCP 232

ITEM PART NO. DESCRIPTION QTY

FINISH PLINTH PART NO. TURNTABLE PART NO.

AFROMOSIA	APLINTH	LP12A
BLACK	BPLINTH	LP12B
WALNUT	WPLINTH	LP12W

TECHNICAL INFORMATION, DRAWINGS, DESIGN AND OTHER DATA SUPPLIED BY LINN ARE CONFIDENTIAL AND WILL NOT, WITHOUT THE PRIOR WRITTEN CONSENT OF LINN, BE DISCLOSED TO ANY THIRD PARTY AND WILL BE USED SOLELY FOR THE PURPOSES OF THE ORDER AND AT ALL TIMES REMAIN THE PROPERTY OF LINN. THIS IS ANGLE PROJECTION.

UNIT OF MEASURE: mm SHEET NO. 1 OF 1 DATE: 30AUG91 SEE CHART

SCALE: NONE MATERIAL: SEE NOTE DRG. NO. LP12A/2

DRAWN: JVA CHD: JVA PASSED: AD TITLE: EXPLODED LP12 TURNTABLE REV. 4